

BNC Conn. Series

Material & Finish

Body: Zinc Alloy Nickel Plating

Insulator: TEFLON

Center Contact : Phosphor Bronze / Gold Plating

Mounting Post: Phosphor Bronze / Tin Plating



BNCR004-F **GW-L**
 5:50 Ω 7:75 Ω

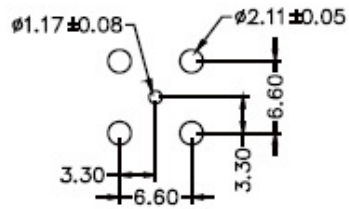
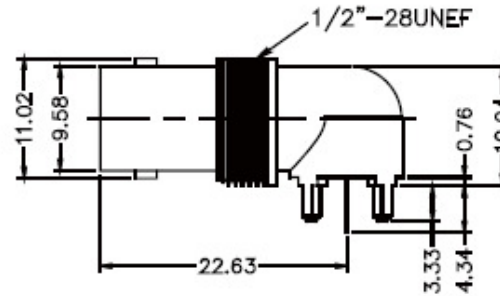
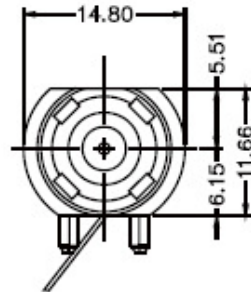

RECOMMENDED PC BOARD LAYOUT
 WITHOUT MOUNTING POSTS

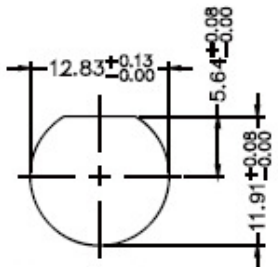
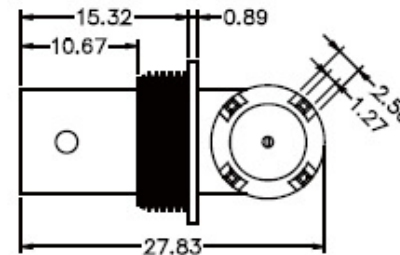

RECOMMENDED MOUNTING HOLE
 MAXIMUM PANEL THICKNESS: 5.5MM

TOPTTEK
 HARDWARE ELECTRONIC COMPONENTS



www.toptek-co.com